

RECORD # 10718

LANGLADE COUNTY SURVEYORS OFFICE

DATE FILED: 3/15/06 BY: D. Tussy

- 3" Capped Iron Pipe
- Set 3/4"X30" Iron Pipe
- 3/4"X24" Iron Bar
- 1"X24" Iron Bar

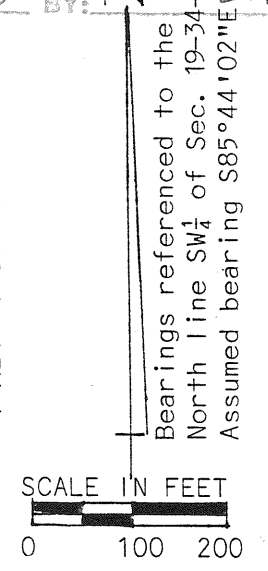

PLAT OF SURVEY FOR ROBERT SCHULZ

I, Edwin R. Abendroth, registered land surveyor, hereby certify that I have surveyed and mapped by the order of Robert Schulz, the Northwest $\frac{1}{4}$ of the Southwest $\frac{1}{4}$ of Section 19, Township 34 North, Range 9 East, Town of Parrish, Laglade County, Wisconsin.

Together with a 33 foot easement over the South 33 feet of the Northeast $\frac{1}{4}$ of the Southwest $\frac{1}{4}$ of said Section, Town and Range, described as follows:

Beginning at the Southwest corner of said Northeast $\frac{1}{4}$ of the Southwest $\frac{1}{4}$; thence $N0^{\circ}53'21''E$, 33.07 feet; thence $S85^{\circ}23'09''E$, 98.21 feet; thence on the westerly line of River Road, $S36^{\circ}53'1''W$, 39.03 feet; thence $N85^{\circ}23'09''W$, 75.22 feet to the point of beginning.

Prepared By:
WISCONSIN VALLEY SURVEYORS
415 W Thomas St
Wausau, WI 54401

Edwin R. Abendroth
Edwin R. Abendroth RLS No. S-798
January 2, 1991

