

Plat of Survey

A parcel of land being part of the Northwest 1/4 of the Northwest 1/4, part of the Northeast 1/4 of the Northwest 1/4, part of the Southeast 1/4 of the Northwest 1/4 and part of the Southwest 1/4 of the Northwest 1/4 of Section 25, Township 30 North, Range 11 East, Town of Rolling, Langlade County, Wisconsin more particularly described as follows:

Commencing at the West 1/4 Corner of Section 25; thence N 0° 41' 48" W, 90.01 feet along the West line of the Northwest 1/4 of Section 25 to the point of beginning of the parcel herein described; thence continuing N 0° 41' 48" W, 699.94 feet along the West line of the Northwest 1/4 of Section 25; thence N 88° 22' 38" E, 125.37 feet; thence N 39° 43' 28" E, 118.16 feet; thence S 86° 49' 03" E, 179.36 feet; thence N 9° 16' 33" E, 178.83 feet; thence N 34° 12' 11" W, 82.56 feet; thence N 0° 17' 13" E, 555.74 feet to the Southeast corner of Volume 3 Certified Survey Maps, Page 95; thence N 0° 41' 09" W, 559.06 feet along the East line of said parcel to the Northeast corner thereof; thence S 89° 49' 16" E, 307.26 feet to the Southwest corner of Lot 1, Volume 7 Certified Survey Maps, Page 68; thence S 0° 41' 45" E, 111.13 feet along the West line of Outlot 1, Volume 8 Certified Survey Maps, Page 138 to the Southwest corner thereof; thence N 85° 37' 41" E, 267.71 feet to the Southeast corner of Outlot 1, Volume 8 Certified Survey Maps, Page 138; thence N 86° 32' 32" E, 265.66 feet to the Southeast corner of Outlot 2, Volume 8 Certified Survey Maps, Page 138; thence N 0° 36' 46" W, 142.13 feet to the Southwest corner of Volume 5 Certified Survey Maps, Page 126; thence S 89° 49' 16" E, 301.80 feet to the Southeast corner of Volume 5 Certified Survey Maps, Page 126; thence N 0° 28' 50" W, 79.91 feet; thence S 89° 49' 16" E, 213.01 feet to the West line of Lot 1, Volume 3 Certified Survey Maps, Page 155; thence S 0° 10' 27" W, 80.00 feet along the West line of Lot 1, Volume 3 Certified Survey Maps, Page 155 to the Southwest corner thereof; thence S 89° 49' 07" E, 528.37 feet along the South line of Volume 3 Certified Survey Maps, Page 155; thence S 0° 26' 21" E, 380.21 feet to the Northeast corner of Lot 1, Volume 12 Certified Survey Maps, Page 48; thence N 89° 46' 36" W, 360.02 feet to the Northwest corner of said Lot 2; thence S 0° 23' 39" E, 360.98 feet to the Southwest corner of Lot 2; thence S 89° 49' 07" E, 360.35 feet to the Southeast corner of said Lot 2; thence S 0° 28' 50" E, 413.03 feet; thence thence N 89° 41' 39" W, 946.26 feet to the West line of the Southeast 1/4 of the Northwest 1/4 of Section 25; thence S 0° 35' 18" E, 495.06 feet along said West line; thence N 89° 41' 39" W, 330.04 feet; thence S 0° 35' 18" E, 660.08 feet to the South line of the Southwest 1/4 of the Northwest 1/4 of Section 25; thence N 89° 41' 39" W, 610.02 feet along said South line; thence N 0° 41' 48" W, 90.01 feet; thence N 89° 41' 39" W, 365.06 feet to the West line of the Northwest 1/4 of Section 25 and the point of beginning of the parcel herein described

Said parcel contains 3,084,682 Square Feet or 70.81 Acres of which 23,116 Square Feet or 0.53 Acres is Road R/W.

Subject to all roadways and easements of record.

SURVEYOR'S CERTIFICATE

I, Daniel E. Higginbotham, Professional Land Surveyor S-1935, do hereby certify to the best of my knowledge and belief that at the direction of Jesse and Wanda Larson, owners, I have surveyed and mapped the lands described hereon. I further certify that said survey and map thereof are a correct and accurate representation of the exterior boundaries of said land and that I have fully complied with the provisions of Wisconsin Administrative Code AE-7 in surveying and mapping said lands.

Dated this 26th day of June, 2025

Dan Higginbotham

P.L.S. No. S-1935

- Wetland Boundary
(See Note)
- X— Fence
 - 3/4" X 18" Iron Rod Set
(1.3 lbs./in. lt.)
 - Found 1" ID Iron Pipe
 - Found 1" OD Iron Pipe
 - Found Govt. Corner
 - () Record Date

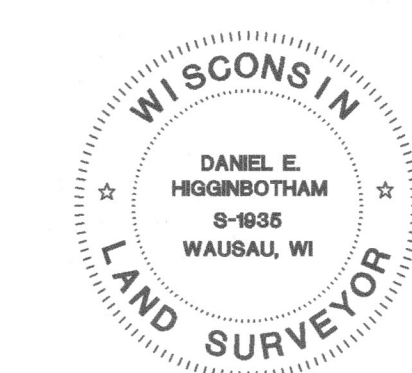
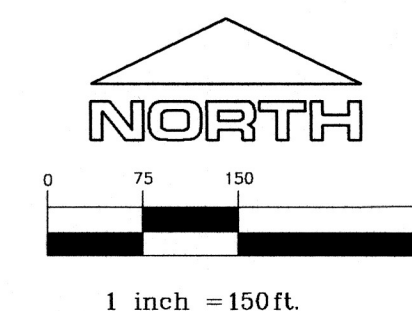

RECORD # 40084
LANGLADE COUNTY SURVEYORS OFFICE
DATE FILED: 6/25 BY: D.E.

SURVEY PROVIDED BY:
PLOVER RIVER LAND CO. 2625 NORTHWESTERN AVENUE WAUSAU, WI 54403 (715)449-2229